

Gas-tight Niskin bottle for sub sampling dissolved gases in water samples.

Based on the standard Niskin bottle design (non-metallic, free-flushing water samplers recommended for general-purpose water sampling), these samplers have been modified to include a gas collection system. The bottles can be individually or serially attached on a hydrocable and activated by a messenger, or placed on a 'Rosette System' and activated by remote command (mounting blocks for 'Rosette Systems' of other manufacturers are available on request: no extra charge).

The PVC-standard water sampler is made of grey PVC (RAL 7011), with a latex tubing spring closure system, clamp bolts for attachment on a cable and mounting blocks for 'Rosette System' attachment.

Delivery is made with lanyards for loading on both cable and 'Rosette Systems'. All metal parts are manufactured from special VA4-stainless steel. Delrin drain valves and Buna O-Rings prevent leakage from the sampler.

The PVC-standard water samplers are available in 1.7 L to 20 L capacities, and are capable of being mounted on cable of up to ¼" (6.4 mm) diameter. All samplers can be mounted on 'Rosette Systems'.

Specifications

- **Mounting:** Cable clamps are for cable diameters up to and including 6.4mm (1/4").
- **Material:** Non-metallic construction of PVC tube section, end stoppers, handles and cable clamp blocks. Delrin stopcocks, air vent screws and push rod. Stainless steel cable clamps. End stopper closure band of latex tubing. Buna-N O-ring seals (other materials available). Nylon monofilament lanyards.
- **End Closure:** Stopper with spherical section sealing surface held firmly against O-ring seal by internal latex tubing.
- **Drainage:** Thumbscrew air vent at top. Stopcock at base: 4.7mm (.187") diameter.

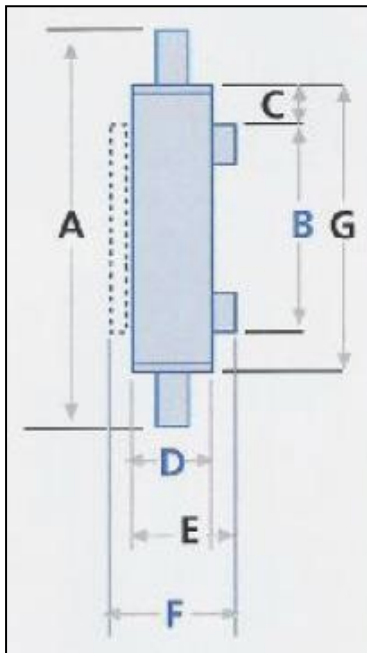
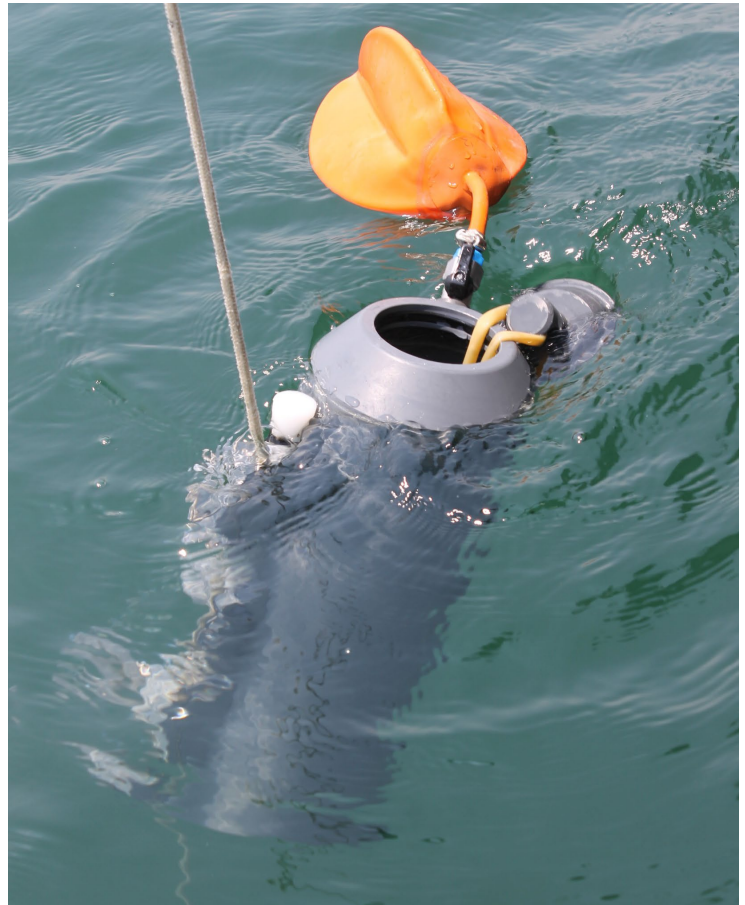

Dimensions		Sampler Capacity (litres)					
		1.7	2.5	5	10	12	20
A	mm	633	838	692	1041	1168	889
B	mm	330	330	330	330	330	330
C	mm	63	63	63	63	63	89
D	mm	89	89	142	142	142	218
E	mm	139	139	192	192	192	273
F	mm	204	204	257	257	257	338
G	mm	457	660	508	863	990	711
Empty Weight	kg	2.5	3.0	3.6	5.7	6.1	11.4
Full Weight	kg	4.20	5.50	8.63	15.63	18.13	31.43
End opening	mm	74					

FOR FURTHER INFORMATION PLEASE CONTACT:

Ocean Scientific International Ltd
 Culkin House, C7/8 Endeavour Business Park,
 Penner Road, Havant, Hampshire PO9 1QN, UK
 T: +44 (0) 2392 488240 E: osil@osil.com W: www.osil.com