

ROV TRIGGERED NISKIN FRAME



Manually activated non-metallic water sampling from an ROV

These systems are used to retrieve multiple water samples by ROV, with space for a CTD probe (or similar instrument to collect background data). The frame is mounted directly on to the ROV and the manual bottle triggering mechanism can be operated using the ROV manipulator, even under difficult conditions.

The samples can be collected at fixed depth, and can be collected in conjunction with other ROV samples.

We specialise in providing cutting edge solutions for marine and environmental problems, and the ROV sampling system is a further example of how we cater to our customers needs and ensure that we provide each application with the most appropriate instrumentation at the highest standard possible.

Applications

- Deep Sea Mining
- Environmental Impact Assessments
- Geochemical analysis
- Interstitial waters
- Oil field cuttings piles
- Biological survey

Specifications

- **Mounting:**
Standard Nylon clamps are for 5L OSIL Niskin Bottles, options are available for different sizes and instruments
- **Material:** 316 Stainless Steel

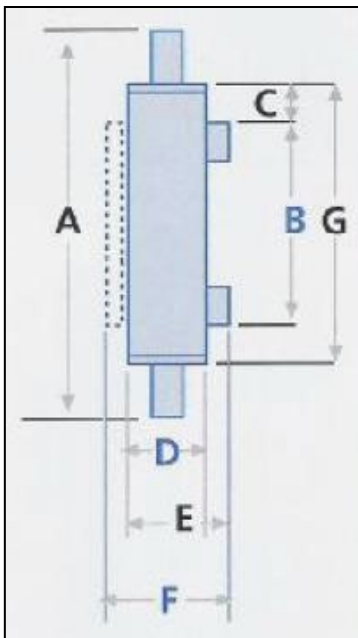

Dimensions		Sampler Capacity (litres)					
		1.7	2.5	5	10	12	20
A	mm	633	838	692	1041	1168	889
B	mm	330	330	330	330	330	330
C	mm	63	63	63	63	63	89
D	mm	89	89	142	142	142	218
E	mm	139	139	192	192	192	273
F	mm	204	204	257	257	257	338
G	mm	457	660	508	863	990	711
Empty Weight	kg	2.5	3.0	3.6	5.7	6.1	11.4
Full Weight	kg	4.20	5.50	8.63	15.63	18.13	31.43
End opening	mm	74					

FOR FURTHER INFORMATION PLEASE CONTACT:

Ocean Scientific International Ltd
Culkin House, C7/8 Endeavour Business Park,
Penner Road, Havant, Hampshire PO9 1QN, UK
T: +44 (0) 2392 488240 E: osil@osil.com W: www.osil.com